



# TITANIUM® WIPER BLADE INSTALLATION

**PART numbers**

604477, 604478, 604479, 604480, 604481, 604482  
604483, 604484, 604485, 604486, 604487, 604488

## BEAM BLADE INSTALLATION WITH HOOK ATTACHMENT

### INSTALLING BEAM HOOK WIPER BLADE

1. Remove Valeo Titanium® Beam wiper blade from packaging.
2. Inspect the pre-installed wiper connector for proper hook adapter installation onto the blade. Ensure the adapter is securely clicked onto the wiper blade by pushing down on the top of the adapter.
3. Follow steps below for installing the wiper blade to the wiper arm:
  - 3a. Position the wiper blade connector under and behind the wiper arm hook.
  - 3b. Once aligned, slide the wiper blade towards the end of the hook and apply pressure until you hear a \*click\*.
  - 3c. Once you hear the \*click\*, pull back gently to ensure the wiper is securely installed to the arm.

**\*NOTE: ONCE INSTALLED, DO NOT AGGRESSIVELY PULL OR TWIST THE CONNECTOR AS THIS MAY CAUSE DAMAGE TO THE ADAPTER RESULTING IN PREMATURE FAILURE**

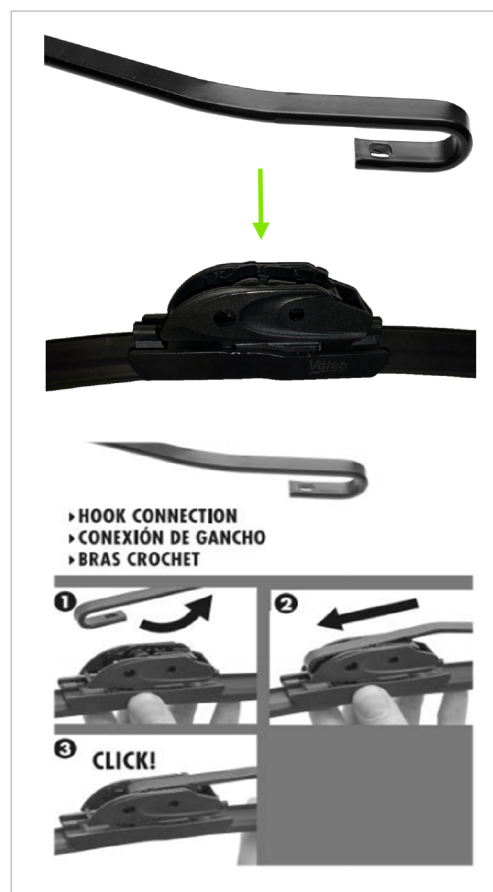

Customer Service: Call 1-888-718-2536 or email us at: [vsus.customerservice.mailbox@valeo.com](mailto:vsus.customerservice.mailbox@valeo.com)

